

REZ #2018-01

Jefferson Square

City Council Public Hearing
January 14, 2019



Overview



- **Location:** Jefferson & Prince William Streets
- **Parcel Size:** ±9.88 acres
- **Zoning:** R-2-S and AOD, Airport Impact Overlay
- **Comprehensive Plan:** Downtown
- **Request:** Rezone to B-3.5 with proffers to allow 85 townhomes and 20 single-family homes

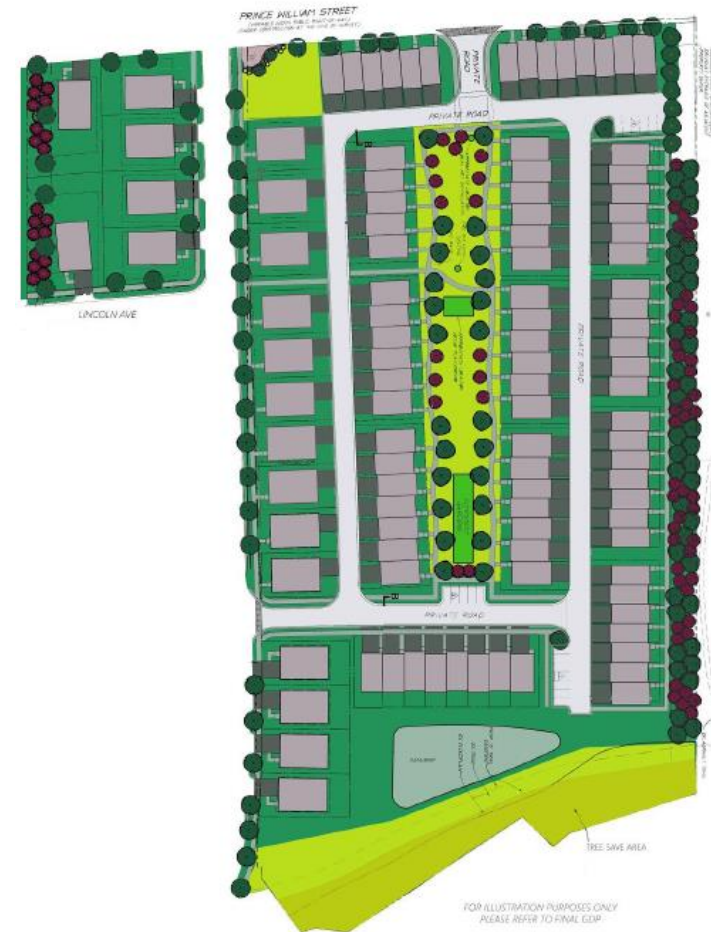

Summary of Changes



- Number and width of townhouse units:

Unit Type	Original Plan (Dec. PH)	Revised Plan
20-ft wide townhomes	81	37
22-ft wide townhomes	8	36
24-ft wide townhomes	0	12
Single-family detached homes	20	20
Total	109	105

- Minor modifications to address sight distance, neighborhood signage, and parking requirements.