

NOTE:
 CONTRACTOR SHALL PROVIDE ACCESS FOR LOCAL RESIDENTS TO THEIR RESPECTIVE DRIVEWAYS AT THE END OF EACH WORK DAY, AND DURING WEEKENDS. THE CONTRACTOR SHALL MAKE PROVISIONS FOR EMERGENCY, MAIL CARRIER, AND GARBAGE COLLECTION VEHICLE ACCESS AT ALL TIMES.

ALL TRAFFIC CONTROL DEVICES SHALL BE IN ACCORDANCE WITH THE MUTCD, AND SHALL BE MODIFIED AS REQUIRED BY THE ENGINEER.

ALL TRAFFIC CONTROL DEVICES SHALL MEET REQUIREMENTS OF N.C.H.R.P. REPORT 350 AS CERTIFIED BY THE MANUFACTURER OF THE DEVICE.

SEE WSDOT STD PLAN K-80.20-00 FOR TYPE III BARRICADE DETAIL. PAINTED RAILS ARE NOT ACCEPTABLE. TYPE III TRAFFIC BARRICADE FACE RAILS SHALL HAVE RETRO-REFLECTORIZED SHEETING ATTACHED.

SIGNS TO BE MOUNTED ON TYPE III BARRICADES UPON ACTUAL CLOSING OF A SECTION OF ROAD.

CONDITION AND CARE OF EQUIPMENT
 ALL TRAFFIC CONTROL DEVICES SHALL BE KEPT CLEAN TO PROVIDE PROTECTION FOR THE CREW THROUGH BETTER VISIBILITY TO THE MOTORIST. THE CONDITION OF SIGNS AND TRAFFIC CONTROL DEVICES SHALL BE NEW OR "ACCEPTABLE" AS DEFINED IN THE BOOK "QUALITY GUIDELINES FOR WORK ZONE TRAFFIC CONTROL DEVICES", AND WILL BE ACCEPTED BASED ON A VISUAL INSPECTION. A SIGN OR TRAFFIC CONTROL DEVICE DETERMINED TO BE "NOT ACCEPTABLE" SHALL BE REMOVED FROM THE PROJECT.

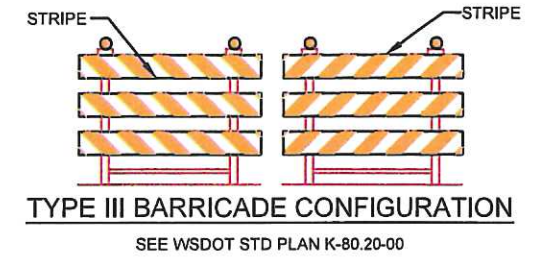

LEGEND

- SIGN SINGLE POST
- SIGN DOUBLE POST
- TYPE III BARRICADE
- PCMS PORTABLE CHANGEABLE MESSAGE SIGN

2009 Edition MUTCD
 Page 581

GUIDANCE:
 14 SIGNS MOUNTED ON TYPE 3 BARRICADES SHOULD NOT COVER MORE THAN 50 PERCENT OF THE TOP TWO RAILS OR 33 PERCENT OF THE TOTAL AREA OF THE THREE RAILS.

SIGN SCHEDULE

SIGN #	SIGN CODE*	QUANTITY	SIZE ENGLISH	COLOR	POST PER SIGN	DESCRIPTION
1	W20-1	5	36X36	BLACK / ORANGE	1	ROAD WORK AHEAD
2	W20-3	5	36X36	BLACK / ORANGE	1	ROAD CLOSED AHEAD
3	R11-2	8	48X30	BLACK / WHITE	1	ROAD CLOSED
4	M4-10L	4	48X18	BLACK / ORANGE	1	DETOUR ARROW LEFT
5	M4-10R	5	48X18	BLACK / ORANGE	1	DETOUR ARROW RIGHT
6	W20-2	5	36X36	BLACK / ORANGE	1	DETOUR AHEAD
7	R11-4	4	60X30	BLACK / WHITE	1	ROAD CLOSED TO THRU TRAFFIC
8	W21-1701	-	36X36	BLACK / ORANGE	1	MOTORCYCLES USE EXTREME CAUTION
9						
10						

*NOTE: SIGN CODES PER MUTCD AND/OR WSDOT SIGN FABRICATION MANUAL

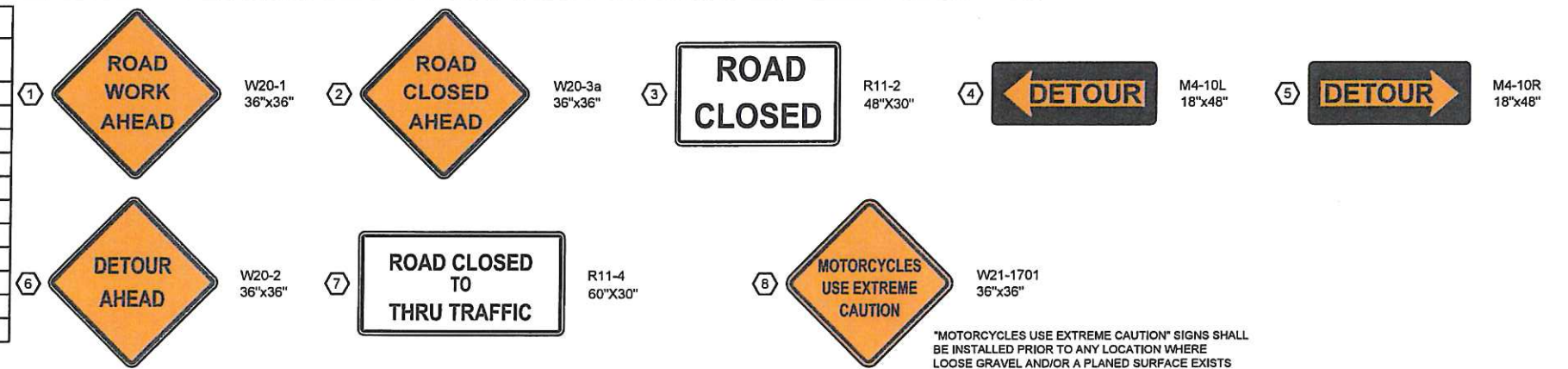

"MOTORCYCLES USE EXTREME CAUTION" SIGNS SHALL BE INSTALLED PRIOR TO ANY LOCATION WHERE LOOSE GRAVEL AND/OR A PLANED SURFACE EXISTS

DRAWN: J. JURGERSON		REGION NO.	STATE
DESIGNER: J. JURGERSON		10	WASH
CHECKED: —		JOB NUMBER	
PROJ. ENG.: S. WALKER		18-04	
APPROVED BY: —		FEDERAL AID PROJECT NO.	HSIP-STPUS-7192 (002) TA-7510
11/7/2022	REV DATE	REVISION	BY APPD

DRAWN: J. JURGERSON		REGION NO.	STATE
DESIGNER: J. JURGERSON		10	WASH
CHECKED: —		JOB NUMBER	
PROJ. ENG.: S. WALKER		18-04	
APPROVED BY: —		FEDERAL AID PROJECT NO.	HSIP-STPUS-7192 (002) TA-7510
11/7/2022	REV DATE	REVISION	BY APPD



Walla Walla County
 PUBLIC WORKS DEPARTMENT



WALLULA AVENUE

TEMPORARY TRAFFIC CONTROL I